

Lindab **Formo**



Installation instruction
Installations vejledning
Montageinstruktion
Asennusohje
Montageanleitung
Istruzioni di montaggio
Instructions de montage
Szerelési útmutató



Formo

Contents	Maintenance / Vedligeholdelse / Underhåll / Huolto / Wartung /	
Indhold	Manutenzione / Entretien / Karbantartás	2
Innehållsförteckning	Symbols / Symboler / Symbolit / Symbole / Simboli / Symboles / Szimbólumok	2
Sisällysluttelo	PKA	3
Inhalt	PCA	4
Sommario	LKA	5
Sommaire	LCA	6
Tartalom	CRL	7
	Accessories - Order code / Tilbehør - Bestillings kode / Tillbehör - Beställningskod /	
	Lisävarusteet - Tilaukoodi / Zubehör - Bestellcode / accessori - Ordinazione	
	/ Accessoires - codification / Kiegészítők	8
	DKZ / DDZ / DCZ	10
	DAZ	13
	DRZ /CAZ	
	Damper / Spjæld / Spjäll / Säätöpelti / Drossel / Serranda / Registre / Szabályozó	14
	MB	
	Plenum box / Trykfordelingsboks / Tryckfördelningslåda / Liitäntälaatikko	
	Anschlusskasten / Plenum / Plénum / Csatlakozó doboz	15
	CBC/CBE	
	Plenum box / Trykfordelingsboks / Tryckfördelningslåda / Liitäntälaatikko	
	Anschlusskasten / Plenum / Plénum / Csatlakozó doboz	16
	Mounting / Ophængning / Uppängning / Kannakointi / Montage / Montaggio / Montage /	
	szereleése	17
	LM	
	Module plates / modulplader / Modulramar / Modulilevy / Modulplatten /Piastra modulare	
	per controsoffiti / Plaque d'habillage / Adapter lemezek	20
	Overview - ceiling systems / oversigt - loftsystemer / Översikt - Undertakssystem /	
	Yleiskatsaus - Kattojärjestelmät / Übersicht - Deckensysteme /	
	Panoramica - Sistemi di controsoffitto / Aperçu - Systèmes de plafond	
	Áttekintés - Álmennyezeti rendszerek	25

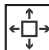
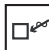
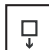
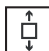
Maintenance	UK - The diffuser can be demounted and vacuum cleaned by using a smooth nozzle brush or wiped off by using a sponge or wiped off with a clean damp sponge or soft cotton cloth.
Vedligeholdelse	DK - Diffusoren kan demonteres og støvsuges med et blødt børstestykke eller aftørres med en fugtig klud.
Underhåll	SE - Donet kan demonteras och dammsugas med ett mjukt borstmunstycke eller torkas av med en fuktig trasa.
Huolto	FI - Laite voidaan puhdistaa imurilla käyttäen pehmeää harjaosaa tai se voidaan pyyhkiä kostutetulla kangasliinalla.
Wartung	DE - Der Durchlass kann zur Reinigung demontiert werden. Die Reinigung erfolgt entweder mit einem Staubsauger mit einer weichen Düsenbürste oder mit einem weichen Baumwolltuch, das in klares Wasser getaucht und gut ausgewrungen wurde.
Manutenzione	IT - Il diffusore può essere pulito con una spazzola morbida oppure con una spugna o un panno di cotone leggermente umidi.
Entretien	FR - Le diffuseur peut être démonté et nettoyé avec une brosse d'aspirateur, une éponge propre ou un chiffon humide doux en coton.
Karbantartás	HU - A befúvó bontható, tisztítható porszívóval, kefével vagy letörölhető szivaccsal vagy lágy pamut ruhával.

Symbols		Supply air		Exhaust air		1, 2, 3 - way
Symboler	Tilluft	fraluft				1, 2, 3 - vejs
Symboler	Tilluft	Frånluft				1, 2, 3 - vägs
Symbolit	Tuloilma	Poistoilma				1, 2, 3 - suuntaa
Symbole	Zuluft	Abluft				1, 2, 3 - seitig
Simboli	Aria di mandata	Aria di estrazione				1, 2, 3 - vie
Symboles	Soufflage	Extraction				1, 2, 3 - directions
Szimbólumok	Befúvás	Elszívás				1, 2, 3 - irányú

Formo

PKA

Measure / weight
 Mål / vægt
 Mått / vikt
 Mitta / paino
 Abmessungen /Gewicht
 Misure / peso
 Dimensions / poids
 Méreték / súly

PKA

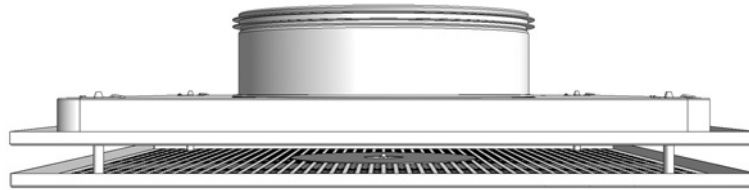

PKA Ød mm	A mm	B mm	U* mm	m kg
125	235	37	200	0,9
160	295	37	260	1,3
200	395	37	360	2,2
250	495	41	460	3,1
315	595	41	560	4,3
400	595	41	560	4,3

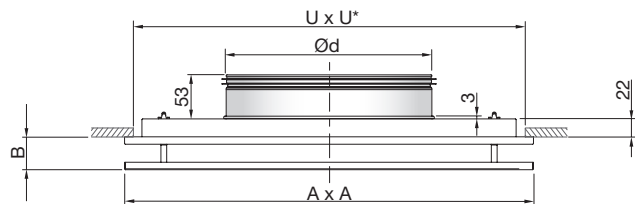

- *UxU Ceiling grid opening
- *UxU Loft udkæring
- *UxU Håltagning
- *UxU Asennusaukko
- *UxU Aussparung erstellen
- *UxU Dimensione del foro
- *UxU Ouverture dans le plafond
- *UxU Mennyezeti nyílás

No tools
 Ingen værktøj
 Inga verktyg
 Ei työkaluja
 Keine Werkzeuge
 Nessun attrezzo
 Sans outil
 Szerszám nem szükséges

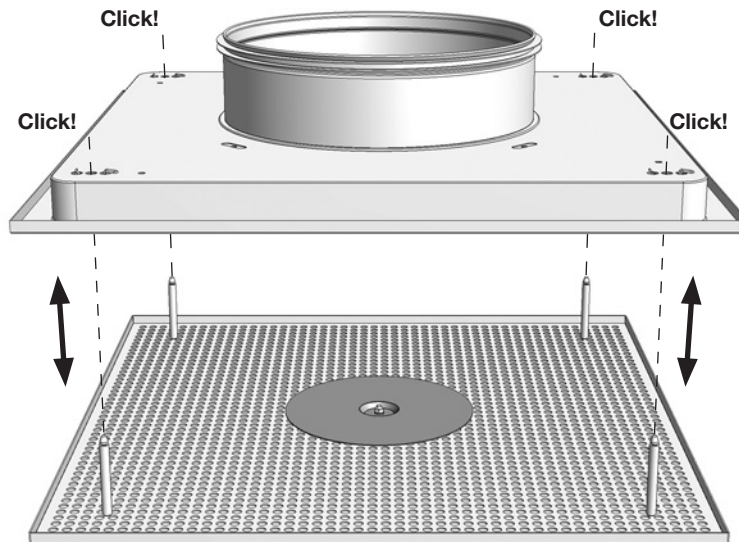

Order code
 Ordre kode
 Beställningskod
 Tuotekoodi
 Bestellcode
 Codice d'ordine
 Codification
 Rendelési kód

PKA — Ød

Formo

PCA

Measure / weight
 Mål / vægt
 Mått / vikt
 Mitta / paino
 Abmessungen / Gewicht
 Misure / peso
 Dimensions / poids
 Méreték / súly

PCA

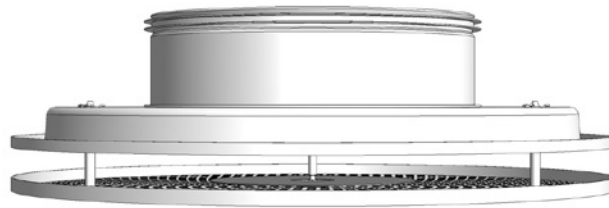

PCA Ød	ØD	ØU*	B	m
mm	mm	mm	mm	kg
100	240	200	37	0,8
125	240	200	37	0,8
160	300	260	37	1,1
200	360	320	37	1,5
250	460	420	41	2,2
315	540	500	41	3,0
400	540	500	41	2,9

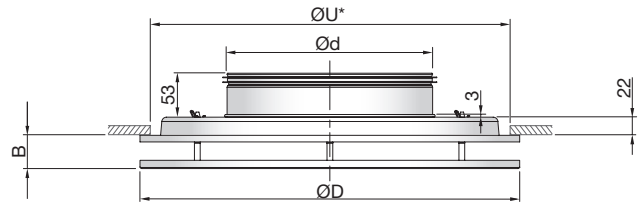

- *ØU Ceiling grid opening
- *ØU Loft udkæring
- *ØU Håltagning
- *ØU Asennusaukko
- *ØU Aussparung erstellen
- *ØU Dimensione del foro
- *ØU Ouverture dans le plafond
- *ØU Mennyezeti nyílás

No tools
Ingen værktøj
Inga verktyg
Ei työkaluja
Keine Werkzeuge
Nessun attrezzo
Sans outil
Szerszám nem szükséges

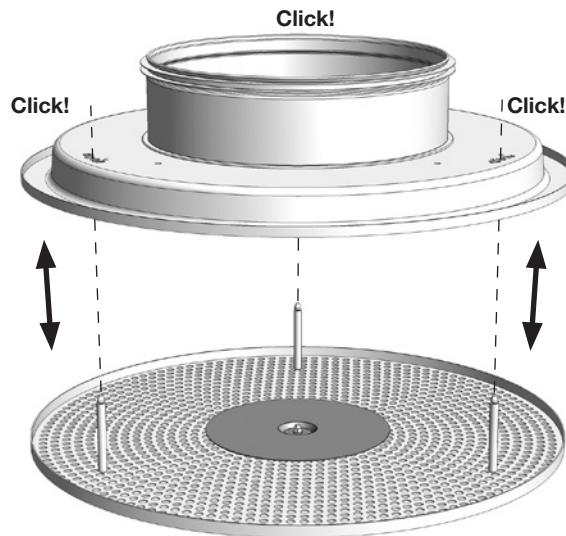

Order code
 Ordre kode
 Beställningskod
 Tuotekoodi
 Bestellcode
 Codice d'ordine
 Codification
 Rendelési kód

PCA — Ød

Formo

LKA

Measure / weight
 Mål / vægt
 Mått / vikt
 Mitta / paino
 Abmessungen / Gewicht
 Misure / peso
 Dimensions / poids
 Méreték / súly

LKA

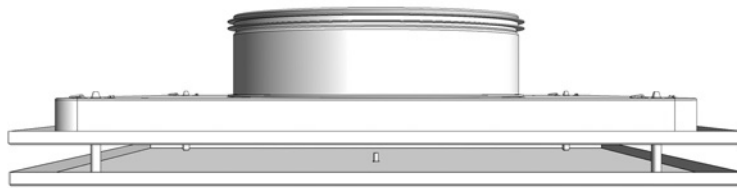

LKA Ød	A	B	U*	m
mm	mm	mm	mm	kg
125	235	37	200	1,0
160	295	37	260	1,5
200	395	37	360	2,5
250	495	41	460	3,7
315	595	41	560	5,1
400	595	41	560	5,1

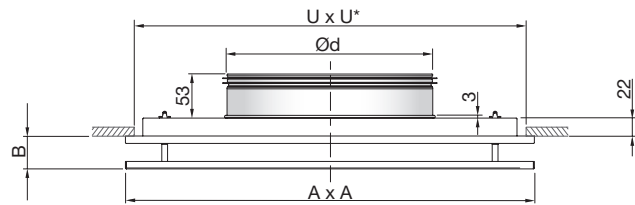

- *UxU Ceiling grid opening
- *UxU Loft udkæring
- *UxU Håltagning
- *UxU Aseennusaukko
- *UxU Aussparung erstellen
- *UxU Dimensione del foro
- *UxU Ouverture dans le plafond
- *UxU Mennyezeti nyílás

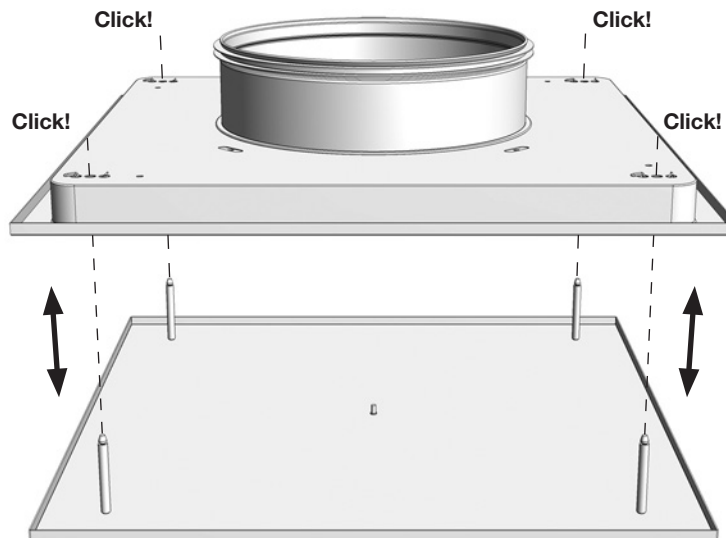

No tools
 Ingen værktøj
 Inga verktyg
 Ei työkaluja
 Keine Werkzeuge
 Nessun attrezzo
 Sans outil
 Szerszám nem szükséges

Order code
 Ordre kode
 Beställningskod
 Tuotekoodi
 Bestellcode
 Codice d'ordine
 Codification
 Rendelési kód

LKA — Ød

Formo

LCA

Measure / weight
 Mål / vægt
 Mått / vikt
 Mitta / paino
 Abmessungen / Gewicht
 Misure / peso
 Dimensions / poids
 Méreték / súly

LCA

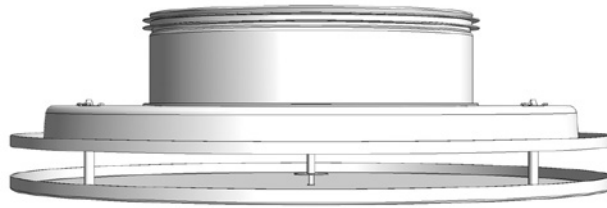

LCA Ød	ØD	ØU*	B	m
mm	mm	mm	mm	kg
100	240	200	37	0,8
125	240	200	37	0,9
160	300	260	37	1,3
200	360	320	37	1,6
250	460	420	41	2,6
315	540	500	41	3,4
400	540	500	41	3,3

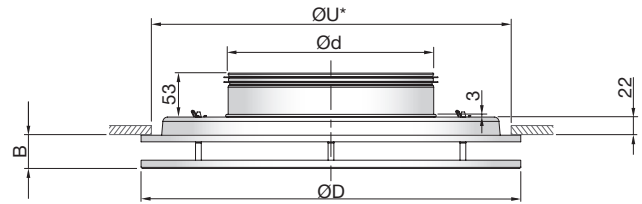

- *ØU Ceiling grid opening
- *ØU Loft udskæring
- *ØU Håltagning
- *ØU Asennusaukko
- *ØU Aussparung erstellen
- *ØU Dimensione del foro
- *ØU Ouverture dans le plafond
- *ØU Mennyezeti nyílás

No tools
 Ingen værktøj
 Inga verktyg
 Ei työkaluja
 Keine Werkzeuge
 Nessun attrezzo
 Sans outil
 Szerszám nem szükséges

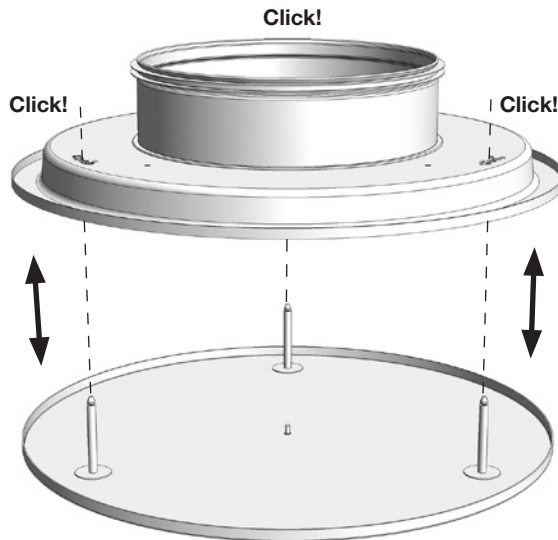

Order code
 Ordre kode
 Beställningskod
 Tuotekoodi
 Bestellcode
 Codice d'ordine
 Codification
 Rendelési kód

LCA — **Ød**

Formo

CRL

Measure / weight
 Mål / vægt
 Mått / vikt
 Mitta / paino
 Abmessungen / Gewicht
 Misure / peso
 Dimensions / poids
 Méreték / súly

CRL

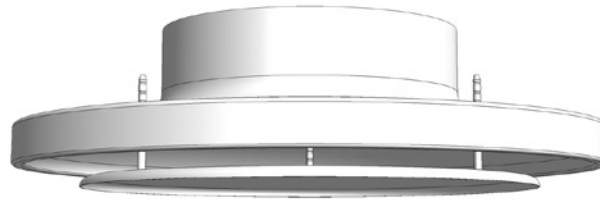

Ød mm	ØA mm	B mm	C mm	ØE mm	ØU* mm	kg
100	188	15	60	146	170	0,3
125	238	20	65	180	210	0,5
160	288	25	65	220	255	0,6
200	388	28	72	300	355	1,1
250	488	33	82	380	390	1,6
315	588	33	97	490	465	2,5
400	720	40	100	590	670	3,8

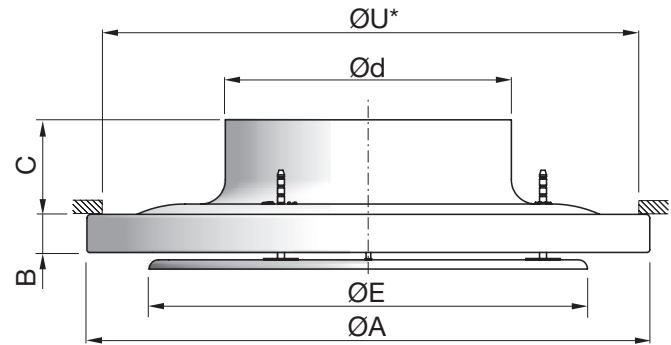

*ØU Ceiling grid opening - *ØU Loft udskæring - *ØU Håltagning - *ØU Asennusaukko - *ØU Aussparung erstellen - *ØU Dimensione del foro
 *ØU Ouverture dans le plafond - *ØU Mennyezeti nyílás

Vertical supply air
 Vertikal tilluft
 Vertikal inblásning
 Pystysuora puhalluskuvio
 Vertikale Luftführung
 Mandata verticale
 Soufflage vertical
 Fügőleges befúvás

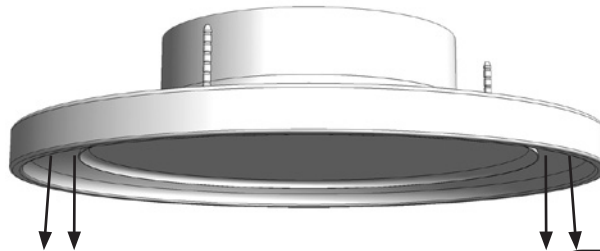

Horizontal supply air
 Horizontal tilluft
 Horisontell inblásning
 Vaakasuora puhalluskuvio
 Horizontale Luftführung
 Mandata orizzontale
 Soufflage horizontal
 Vízszintes befúvás

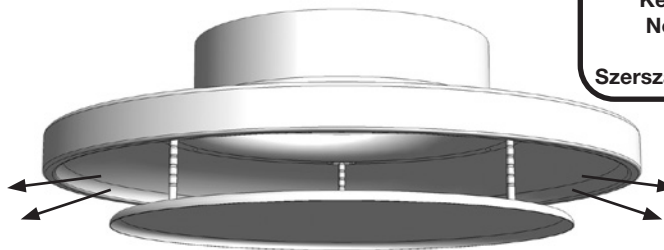

No tools
 Ingen værktøj
 Inga verktyg
 Ei työkaluja
 Keine Werkzeuge
 Nessun attrezzo
 Sans outil
 Szerszám nem szükséges

Order code
 Ordre kode
 Beställningskod
 Tuotekoodi
 Bestellcode
 Codice d'ordine
 Codification
 Rendelési kód

CRL — Ød

Formo

Accessories / Order code
 Tilbehør / Bestillings kode
 Tillbehör / Beställningskod
 Lisävarusteet / Tilauskoodi
 Zubehör / Bestellbeispiel
 Accessori / Ordinanza
 Accessoires / codification
 Kiegészítők / Rendelési kód

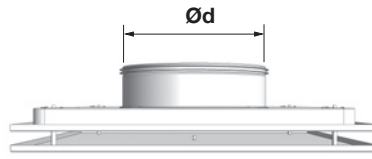

DKZ/DDZ/DCZ

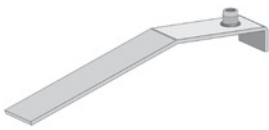

DKZ (PKA, LKA)
DDZ (PCA, LCA)
DCZ (CRL)

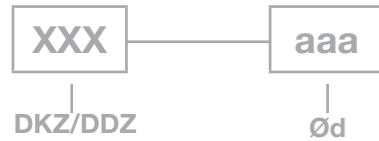

DAZ

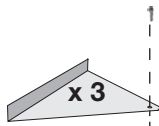

DRZ / CAZ

Damper - Spjæld - Spjäll - Säästöpelti -
 Drossel - Serranda - Registre - Szabályozó



DRZ (PKA, PCA, LKA, LCA)



CAZ (CRL)

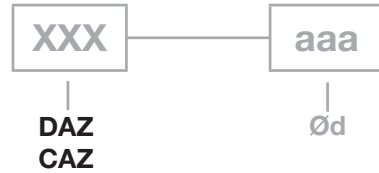

MB

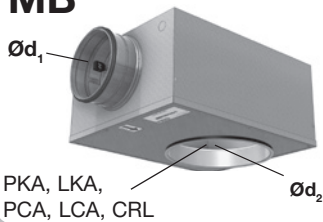

PKA, LKA,
 PCA, LCA, CRL

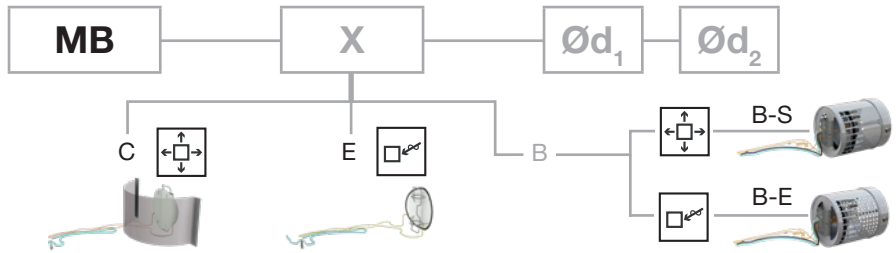

LM

PKA, LKA, PCA, LCA

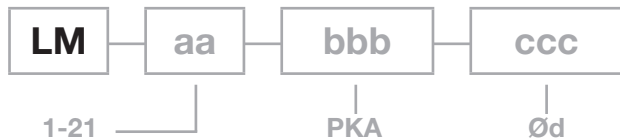
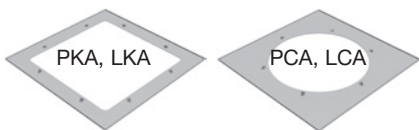

Ceiling system / Loftsystem
 Undertakssystem / Kattojärjestelmä
 Deckensysteme
 Sistemi di controsoffitto
 Type de plafond
 Álmennyezeti rendszer

Formo

Accessories / Order code
 Tilbehør / Bestillings kode
 Tillbehör / Beställningskod
 Lisävarusteet / Tilauskoodi
 Zubehör / Bestellbeispiel
 Accessori / Ordinazione
 Accessoires / codification
 Kiegészítők / Rendelési kód

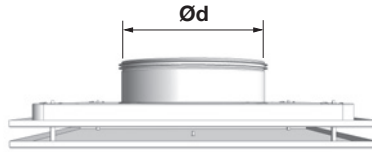

DKZ/DDZ

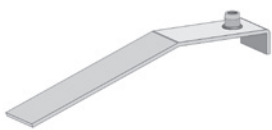

DKZ (PKA, LKA)
 DDZ (PCA, LCA)

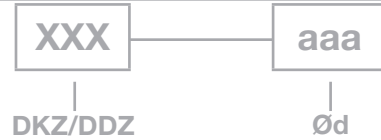

DAZ

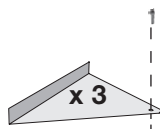

DRZ

Damper - Spjæld - Spjäll - Säästöpelti -
 Drossel - Serranda - Registre - Szabályozó



DRZ (PKA, PCA, LKA, LCA)



CBC/CBE

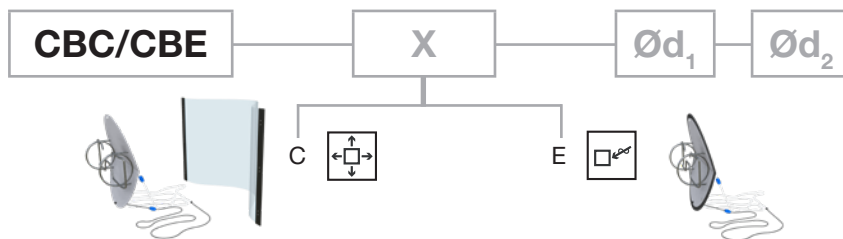

LM

PKA, LKA, PCA, LCA

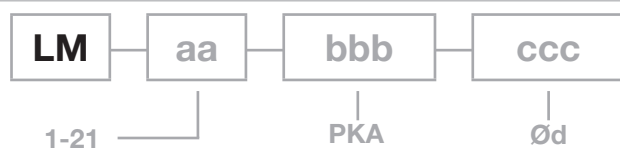
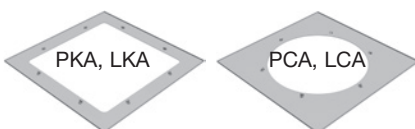

Ceiling system / Loftsystem
 Undertakssystem / Kattojärjestelmä
 Deckensysteme
 Sistemi di controsoffitto
 Type de plafond
 Álmennyezeti rendszer

Formo

DKZ/DDZ/DCZ

Accessories
 Tilbehør
 Tillbehör
 Lisävarusteet
 Zubehör
 Accessori
 Accessoires
 Kiegészítők

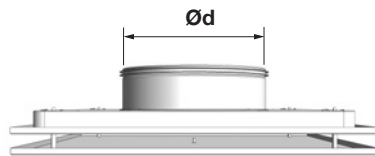

DKZ/DDZ/DCZ

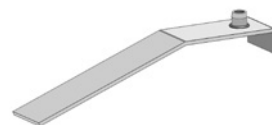

DKZ/DDZ/DCZ

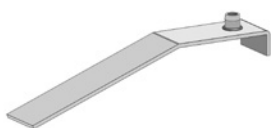

DKZ (PKA, LKA)
DDZ (PCA, LCA)
DCZ (CRL)

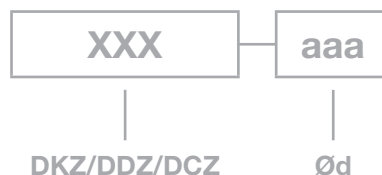

Set / Sæt / Sats / Setti / Set / Set / Kit / Készlet			
DKZ (PKA / LKA)	=		x 4
DCZ (CRL)	=		x 3
DDZ (PCA / LCA)	Ød =125 =		x 2
	Ød >125 =		x 4

PKA, LKA

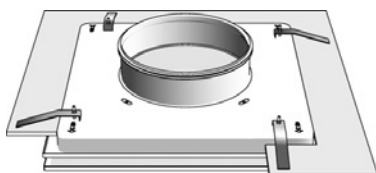

PCA, LCA



CRL

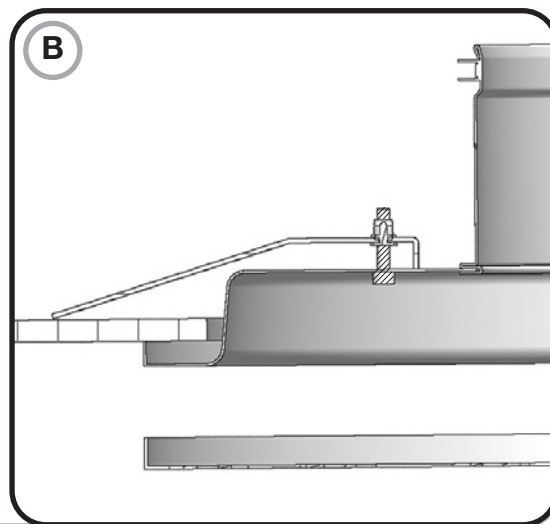
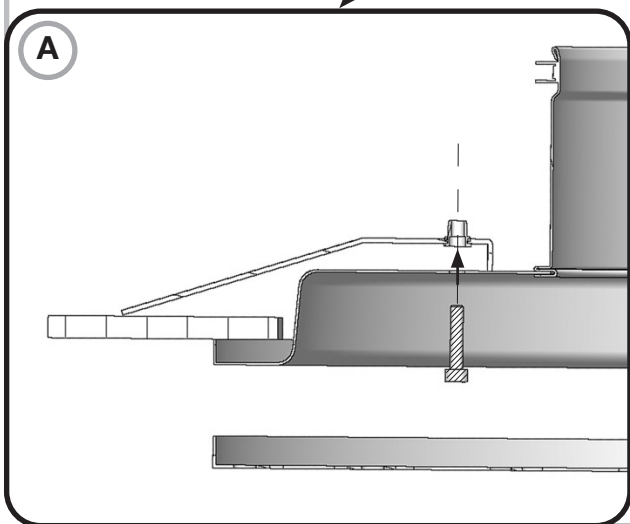
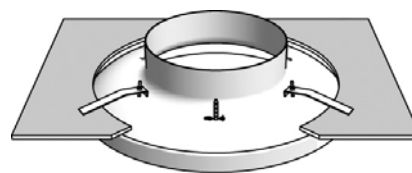

FORMO

DKZ/DDZ/DCZ

Ceiling grid opening
 Udsparing
 Håltagning
 Rakenneaukko
 Aussparung erstellen
 Dimensione del foro
 Ouverture dans le plafond
 Mennyezeti nyílás

DKZ/DDZ/DCZ

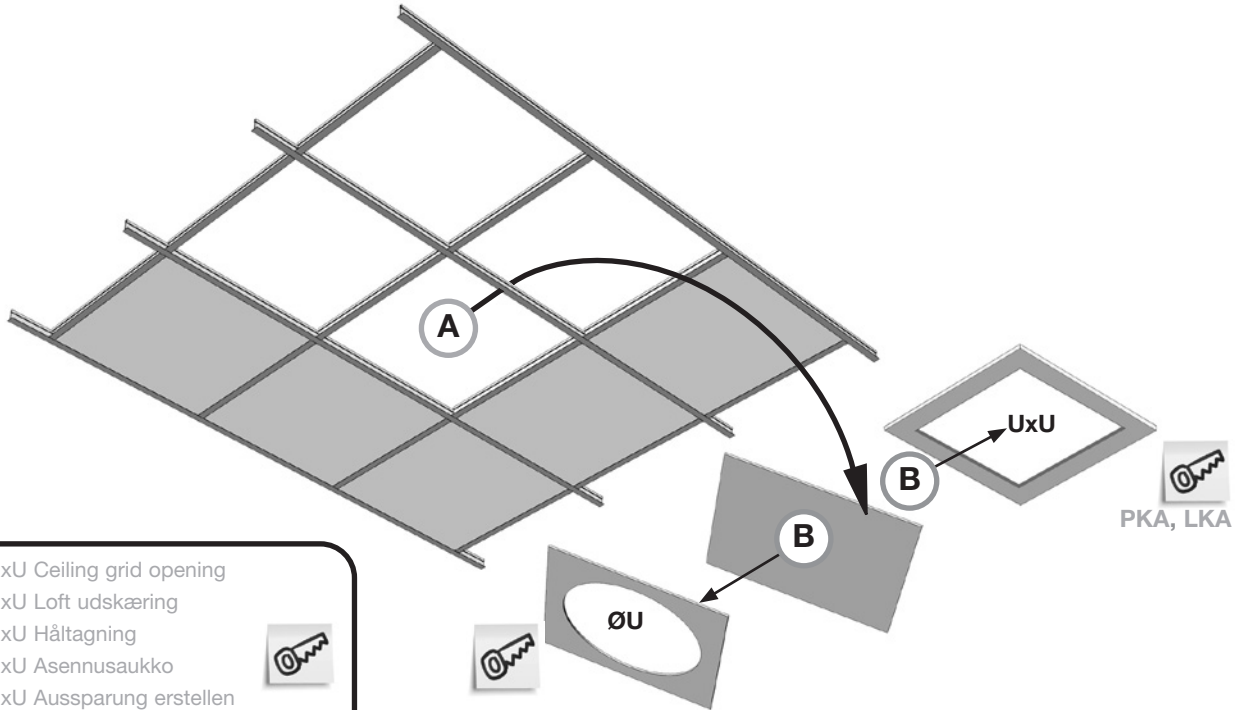
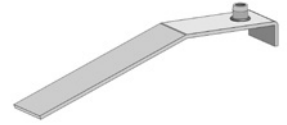

ØU / UxU Ceiling grid opening
 ØU / UxU Loft udkæring
 ØU / UxU Håltagning
 ØU / UxU Asennusaukko
 ØU / UxU Aussparung erstellen
 ØU / UxU Dimensione del foro
 ØU / UxU Ouverture dans le plafond
 ØU / UxU Mennyezeti nyílás



PKA, LKA

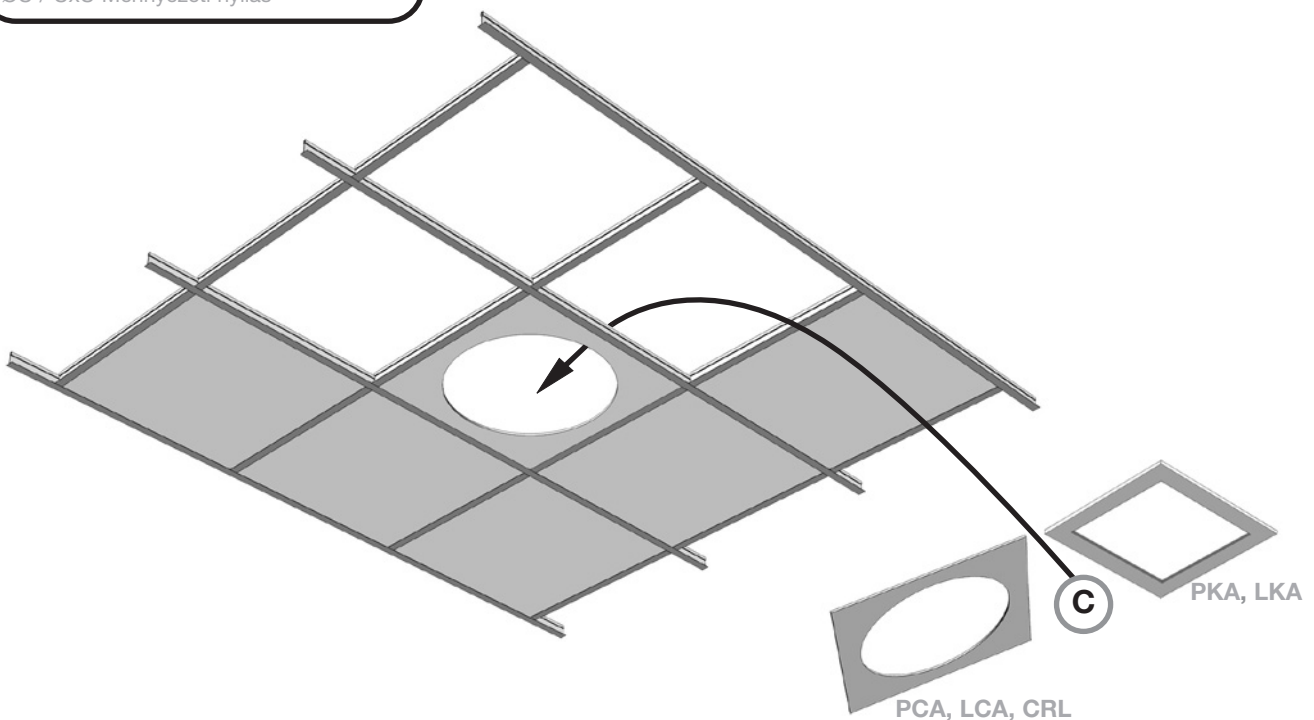

PCA, LCA, CRL

PKA, LKA



FORMO

DKZ/DDZ/DCZ

Mount diffuser with mounting brackets
Monter armatur med monteringsbøjler
Montera don med monteringsklammer
Hajottajan asennus kannakkeiden avulla
Montieren Sie der Durchlass mit Montagebügel
Installazione del diffusore con staffe di montaggio
Installation du diffuseur avec pattes de montage
Befűvő szerelése szerelő konzollal

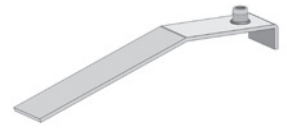
DKZ/DDZ/DCZ



Set / Sæt / Sats / Saja / Set / Set / Set / Kit			
DKZ (PKA / LKA)	=		x 4
DCZ (CRL)	=		x 3
DDZ (PCA / LCA)	Ød =125 =		x 2
	Ød >125 =		x 4

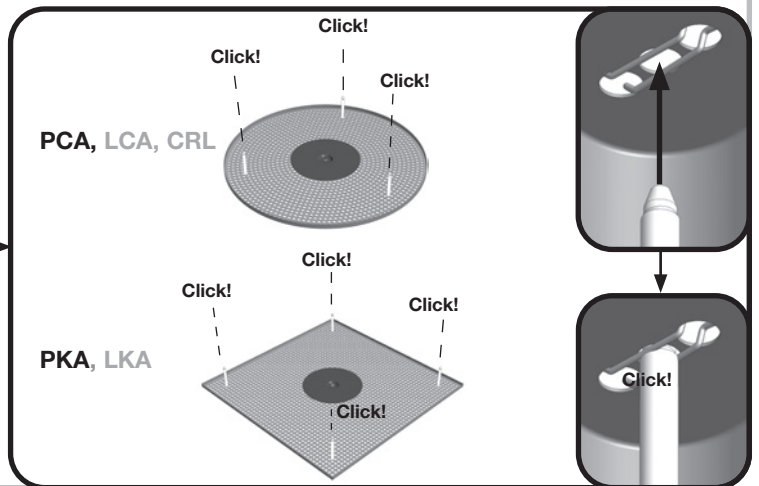
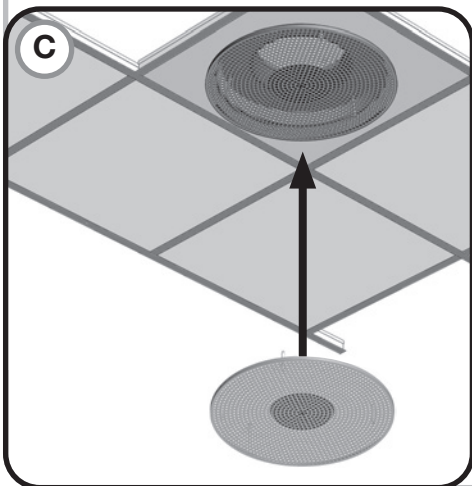
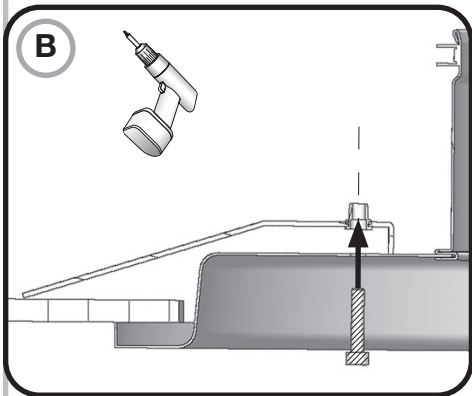
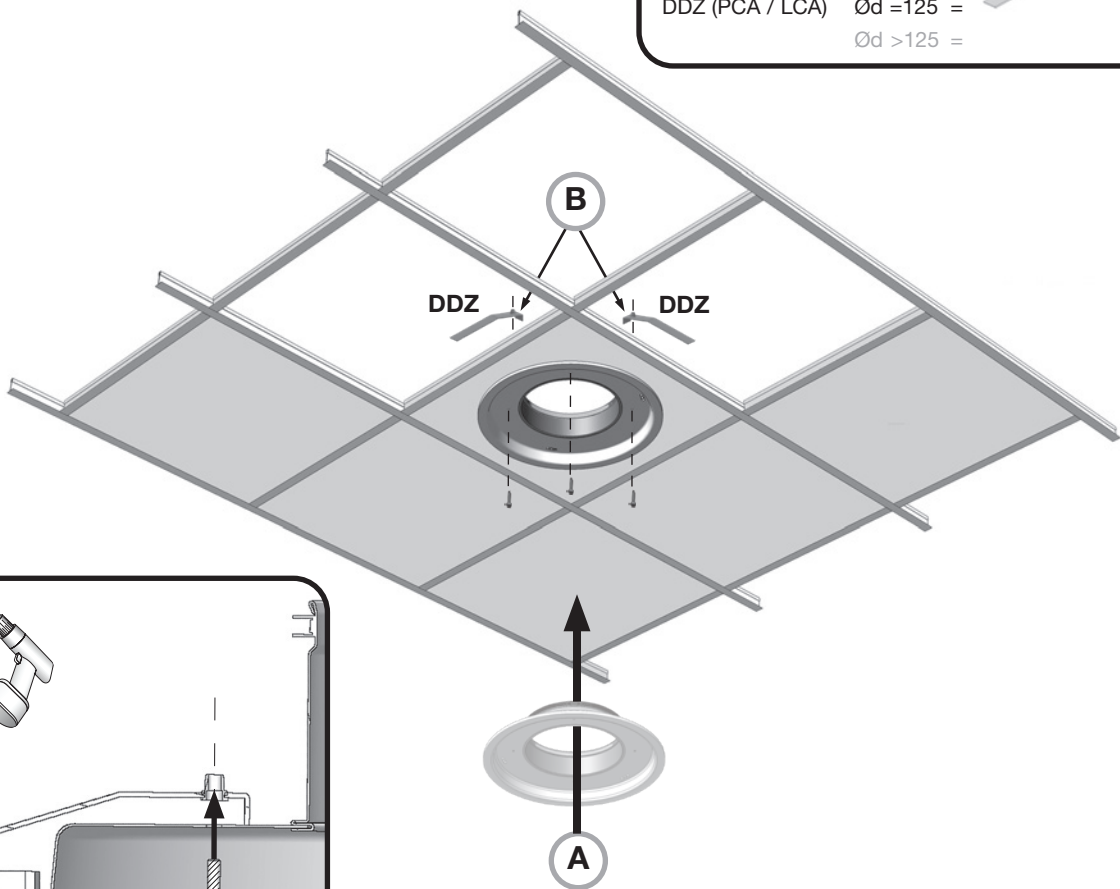

Formo

DAZ

Accessories
Tilbehør
Tillbehör
Lisävarusteet
Zubehör
Accessori
Accessoires
Kiegészítők

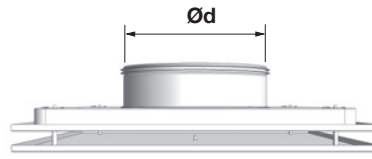

DAZ



PKA, LKA, PCA, LCA

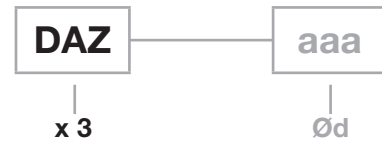

Set / Sæt / Sats / Setti
Set /Set (ITA) / Kit / Készlet

PKA, LKA

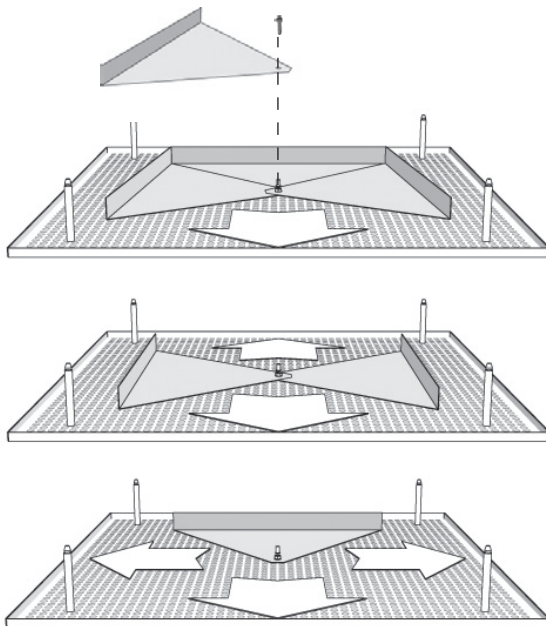

PCA, LCA

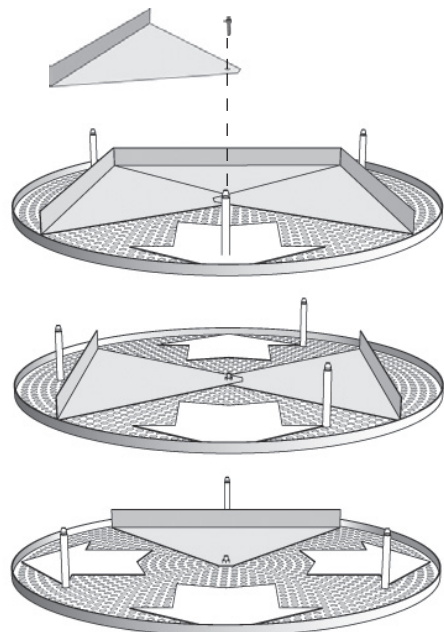

- UK** - DAZ is not used with CRL
- DK** - DAZ anvendes ikke til CRL
- SE** - DAZ används inte för CRL
- FI** - Lisävarustetta DAZ ei käytetä CRL:n kanssa.
- DE** - DAZ wird nicht mit CRL verwendet!
- ITA** - DAZ non usato per CRL
- FR** - DAZ n'est pas compatible avec CRL
- HU** - DAZ-t nem használjuk CRL-hez

Formo

DRZ/CAZ

Accessories - Damper
 Tilbehør - Spjæld
 Tillbehör - Spjäll
 Lisävarusteet - Säätöpelti
 Zubehör - Drossel
 Accessori - Serranda
 Accessoires - Registre
 Kiegészítők / Szabályozó

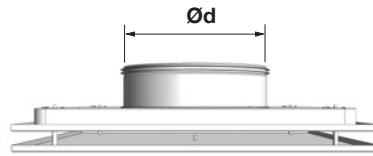

DRZ / CAZ



DRZ / CAZ Damper - Spjæld - Spjäll - Säätöpelti -
 Drossel - Serranda - Registre - Szabályozó

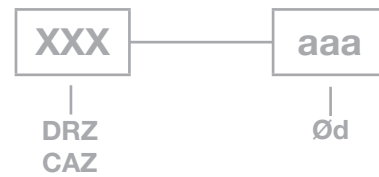

DRZ (PKA, PCA, LKA, LCA)

CAZ (CRL)

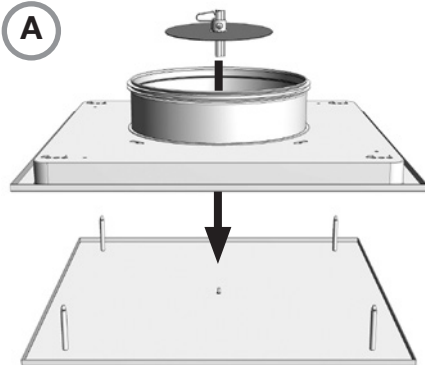

Without deflector plate
 Uden preplade
 Utan avskärningsplåt
 Ilman suojalevyä
 Ohne Prallplatte - DE
 Senza piastra deflettrice
 Sans plaque déflectrice
 Tereelőlemez nélkül

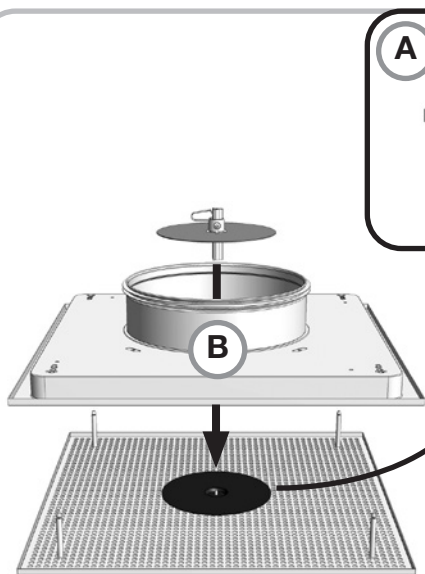
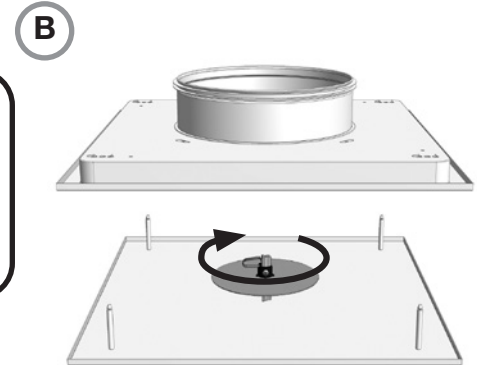

A Demount nut - if deflector plate is included
 Demonter møtrik - hvis preplade er inkluderet
 Demontera mutter - om avskärningsplåt är inkluderad
 Irrota mutteri, jos suojalevy on mukana
 Prallplatte über Mutter lösen und Drossel aufschrauben - DE
 Dado di smontaggio - con piastra deflettrice inclusa
 Démonter l'écrou - si la plaque déflectrice est incluse
 Bontható csavar - ha a tereelőlemez is tartalmazza

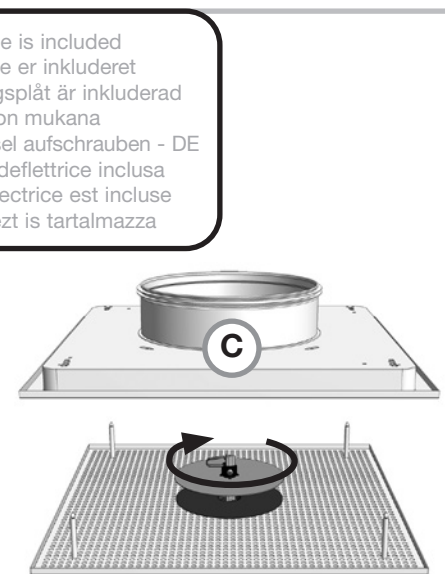

Formo

MB

Dimensions MB
 Dimensioner MB
 Dimensioner MB
 Mitat MB
 Dimensionen MB
 Dimensioini MB
 Dimensions MB
 MB méretek

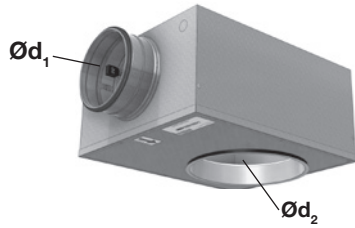

Damper options
 Spjæld varianter
 Spjällalternativ
 Säätöpeltivaihtoehdot
 Drosselvarianten
 Serranda disponibili
 Type de registres
 Szabályozó lehetőségek

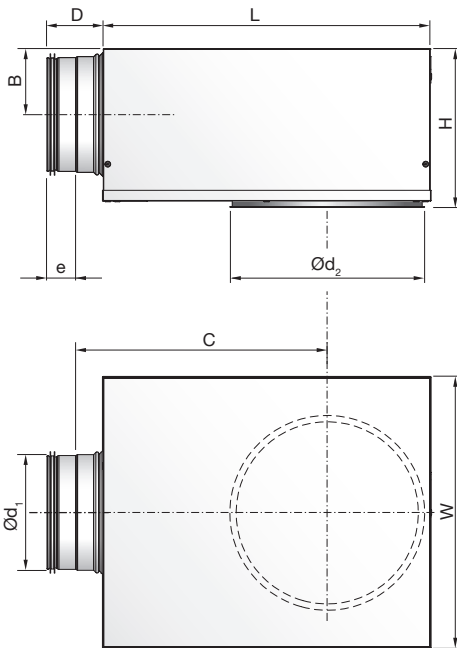

Ød ₁ mm	Ød ₂ mm	B	C	D	e	H	L	W	m kg
100	100*	62	245	78	40	163	310	260	2,6
100	125	62	245	78	40	163	310	260	2,6
100	160	62	245	78	40	163	310	260	2,6
125	125*	75	291	78	40	188	376	310	3,7
125	160	75	291	78	40	188	376	310	3,7
125	200	75	291	78	40	188	376	310	3,7
160	160*	92	352	78	40	222	459	380	5,5
160	200	92	352	78	40	222	459	380	5,5
160	250	92	352	78	40	222	459	380	5,5
200	200*	112	425	78	40	263	565	460	7,3
200	250	112	425	78	40	263	565	460	7,3
200	315	112	425	78	40	263	565	460	7,3
250	250*	137	534	118	60	313	698	540	10,6
250	315	137	534	118	60	313	698	540	10,6
250	400	137	534	118	60	313	698	540	10,6
315	315*	170	695	118	60	378	858	540	13,5
315	400	170	695	118	60	378	858	540	13,5

*) Ød₁ = Ød₂ Not available in Sweden, except 315-315 (with some diffusers).

*) Ød₁ = Ød₂ Ej tillgänglig i Sverige, undantaget 315-315 (med vissa don).
 !  PC6, PC7, RC14, RC15, NC19, LCC, LCP, LKP PS1-V, PS8-V RS14-V, RS15-V, RS16-V, GS23-V

MBB-S

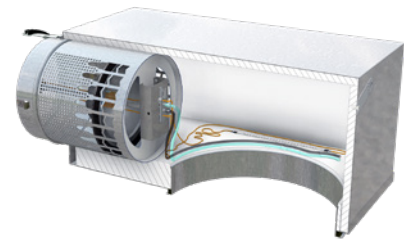
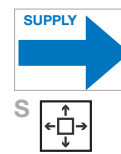

MBB-E

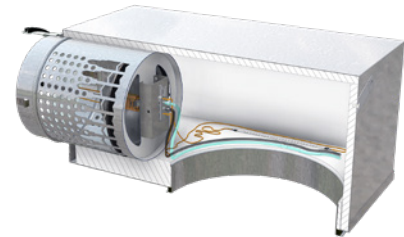

MBC

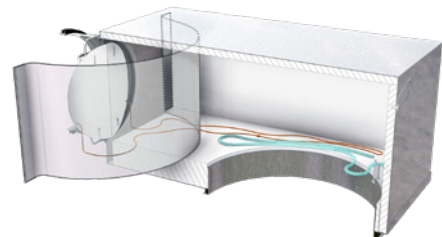
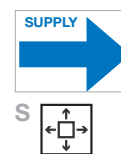

MBE

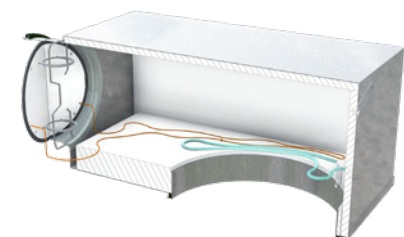

Formo

CBC/CBE

Dimensions CBC/CBE
Dimensioner CBC/CBE
Dimensioner CBC/CBE
Mitat CBC/CBE
Dimensionen CBC/CBE
Dimensioni CBC/CBE
Dimensions CBC/CBE
CBC/CBE méretek



Damper options
Spjæld varianter
Spjällalternativ
Säätöpeltevaihtoehdot
Drosselvarianten
Serranda disponibili
Type de registres
Szabályozó lehetőségek

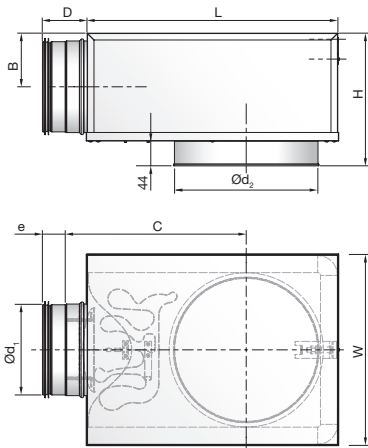

CBC

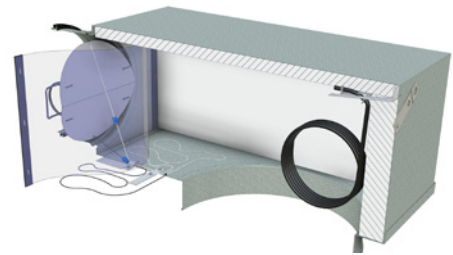
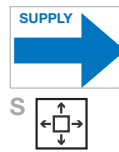

CBE

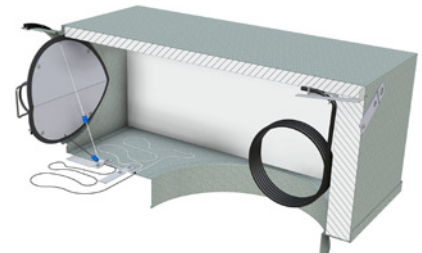

Ød ₁	Ød ₂	B	C	D	e	H	L	W	m
mm					mm				kg
100	125	65	213	78	40	175	277	213	1.4
100	160	65	231	78	40	175	312	248	1.6
125	160	78	250	78	40	200	331	248	1.9
125	200	78	270	78	40	200	371	288	2.3
160	200	95	295	78	40	234	396	288	2.6
160	250	95	320	78	40	234	446	338	3.1
200	250	115	345	78	40	274	471	338	3.6
200	315	115	377	78	40	274	536	403	4.3
250	315	140	423	118	60	325	563	405	6.5
250	400	140	466	118	60	325	648	490	8.6
315	400	173	536	118	60	390	718	490	9.8

Formo

MB/CBC/CBE

- Mounting of MB/CBC/CBE - MHS
- Ophængning af MB/CBC/CBE - MHS
- Upphängning av MB/CBC/CBE - MHS
- Kannakointi MB/CBC/CBE - MHS
- Montage des MB/CBC/CBE - MHS
- Montaggio di MB/CBC/CBE - MHS
- Montage de MB/CBC/CBE - MHS
- MB/CBC/CBE szerelése - MHS

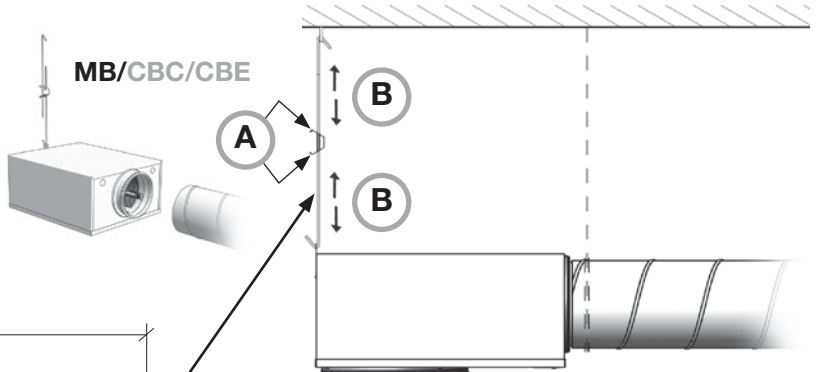
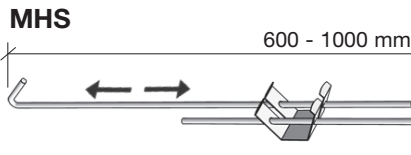

- Threaded bar
- Gevindstang
- Gångstång
- Kierretanko
- Gewindestange
- Barre filettate
- Tiges filetées
- Menetes szár

M8



MB/CBC/CBE

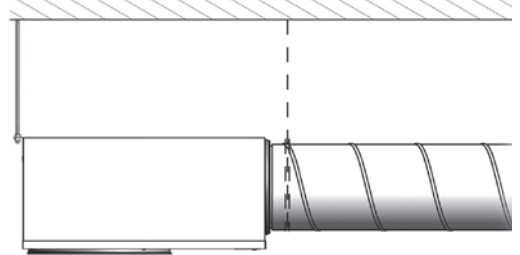
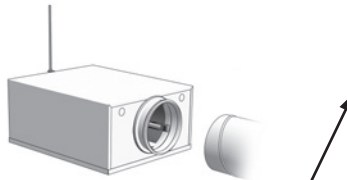

- Directly against ceiling
- Direkte mod loft
- Dikt mot tak
- Suoraan kattopintaan
- Direkt an die Decke
- Direttamente a soffitto
- Directement contre le plafond
- Közvetlenül a mennyezetre

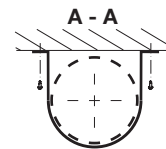
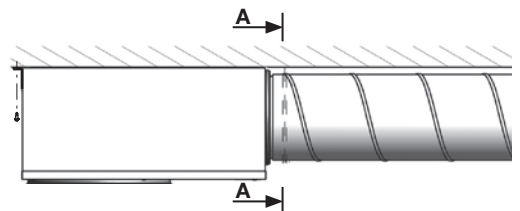
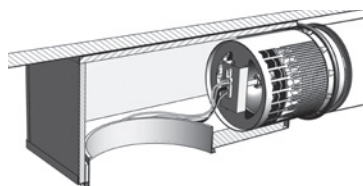

- Mounting of MB/CBC/CBE, details go to - Mounting -and balancing instruction
- Ophængning af MB/CBC/CBE, detaljer se - Montage -og indregulerings vejledning
- Upphängning av MB/CBC/CBE, detaljer gå till - Montage och injusteringsinstruktion
- Kannakointi MB/CBC/CBE, lisätietoja oppaasta - Asennus- ja säätöohjeet
- Montage des MB/CBC/CBE, details go to - Montage und Einregulierungsanweisung
- Montaggio di MB/CBC/CBE, per dettagli vedere - Istruzioni di montaggio e bilanciamento
- Montage de MB/CBC/CBE, détails voir - Instructions de montage et réglage
- MB/CBC/CBE doboz szerelése, részleteket lásd - Szerelési útmutató

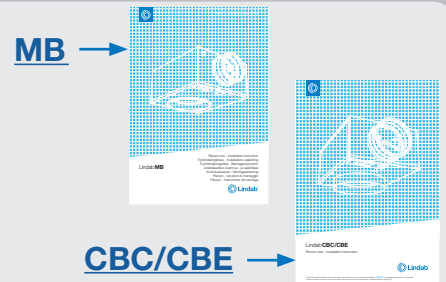

Formo

MB/CBC/CBE

Mounting of diffuser in MB/CBC/CBE
Montering af armatur i MB/CBC/CBE
Montering av don i MB/CBC/CBE
Hajottajan asennus liitännälaitikkoon MB/CBC/CBE
Durchlassmontage im MB/CBC/CBE
Montaggio del diffusore in MB/CBC/CBE
Montage du diffuseur dans MB/CBC/CBE
Befúvó szerelése MB/CBC/CBE dobozba

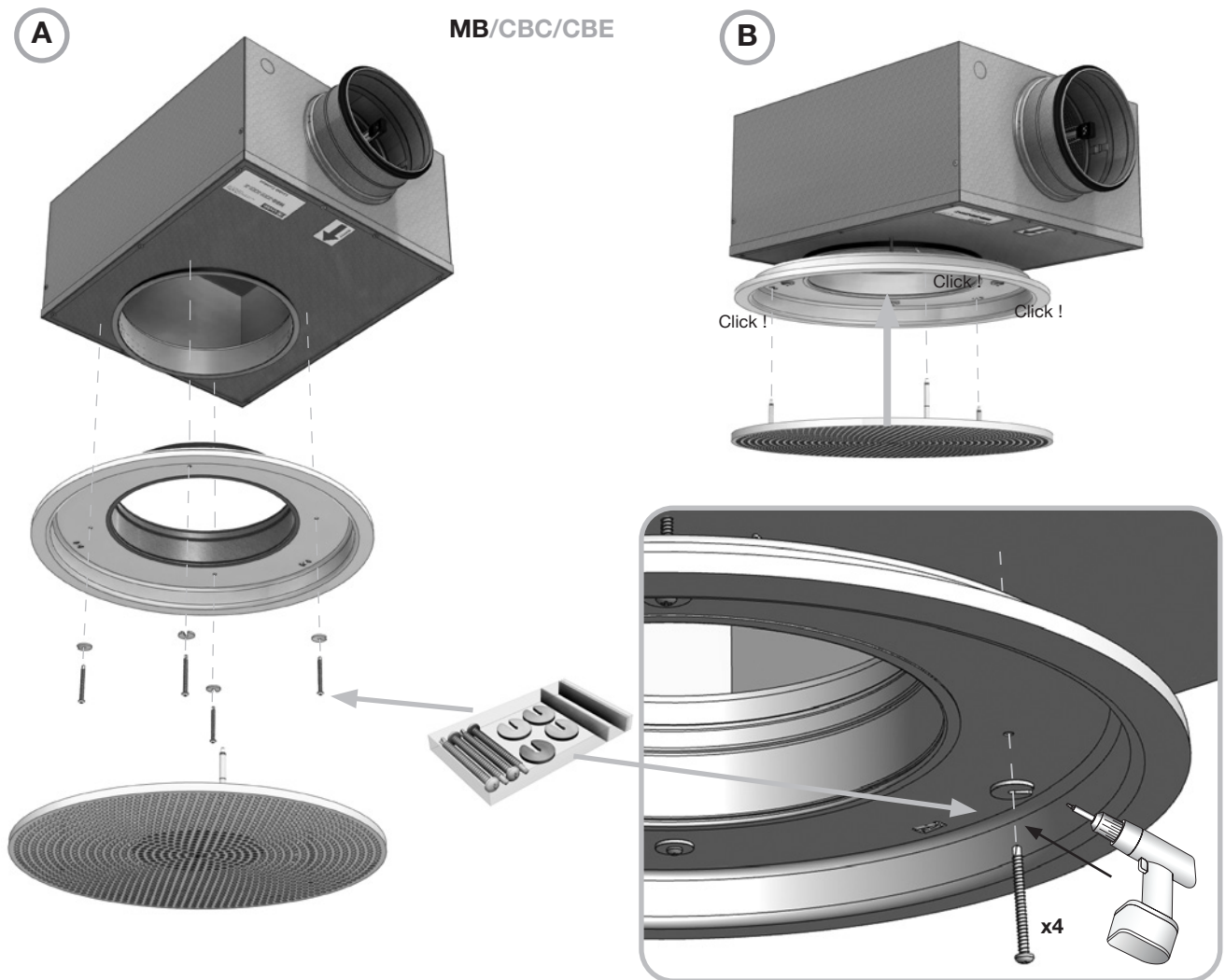

Formo

MB/MBZ

- MBZ - Optional accessories
- MBZ - Ekstra tilbehør
- MBZ - Tillbehör som tillval
- MBZ - Lisavarusteet tilauksesta
- MBZ - Verlängerungsstutzen
- MBZ - Accessori su richiesta
- MBZ - Accessoires optionnels
- MBZ - Opcionális kiegészítők

MBZ

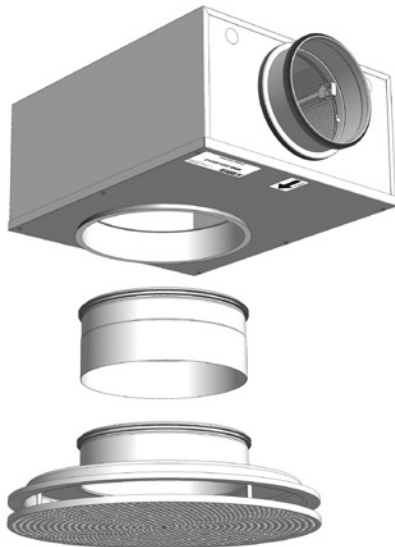
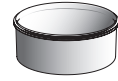

MB/CBC/CBE

- Extension piece
- Forlængerstykke
- Förlängningsstos
- Jatkokappale
- Verlängerungsstutzen
- Manicotto maschio femmina di prolungamento
- Rallonge
- Toldó elem

Using CRL + MB	=>	Always use MBZ !
Anvendelse af CRL + MB	=>	Brug altid MBZ !
Användning av CRL + MB	=>	Använd alltid MBZ !
Käytettäessä CRL+MB	=>	Käytä aina MBZ-liitososa!
CRL + MB	=>	immer MBZ verwenden !
Per CRL + MB	=>	Usare sempre MBZ!>
Utiliser CRL + MB	=>	Toujours utiliser MBZ
CRL + MB használat	=>	Használjon mindig MBZ-t!

This will ensure full motion of faceplate
 Dette vil sikre fuld bevægelse af bundpladen
 Detta kommer att säkerställa full rörlighet av bottenplattan
 Tämä takaa etulevyn täyden liikkuvuuden.
 Dies garantiert die Verstellbarkeit der Frontplatte! - DE
 Questo assicura la completa mobilità della piastra frontale
 Ceci permettra l'utilisation optimale du cône réglable
 Ez biztosítja a frontlap teljes mozgását

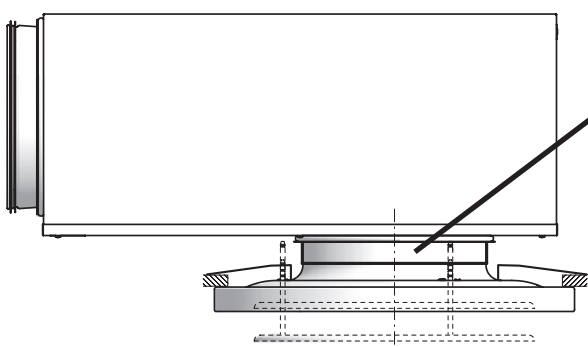
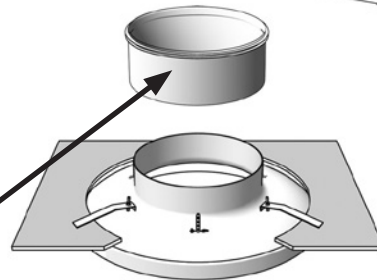
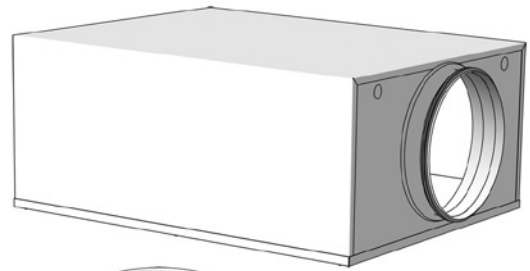

Formo

LM

Mounting of diffuser on the LM module plate
Montering af armatur på LM modulplade
Montering av don på LM modulram
Hajottajan asennus LM-moduulilevyyn
Montage des Durchlasses an der Modulplatte LM
Montaggio del diffusore su cornice LM
Montage du diffuseur sur la plaque d'habillage LM
A befűvő szerelése az LM adapter lemezre

LM

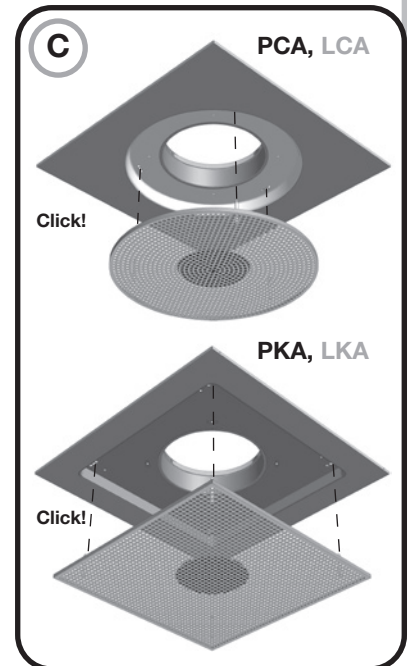
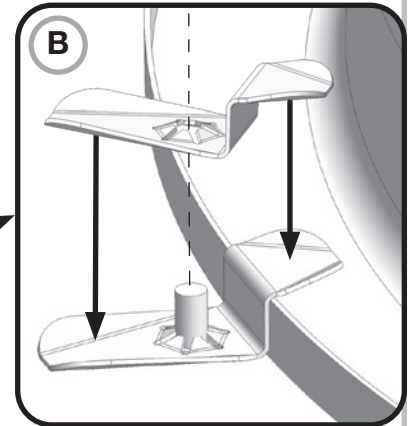
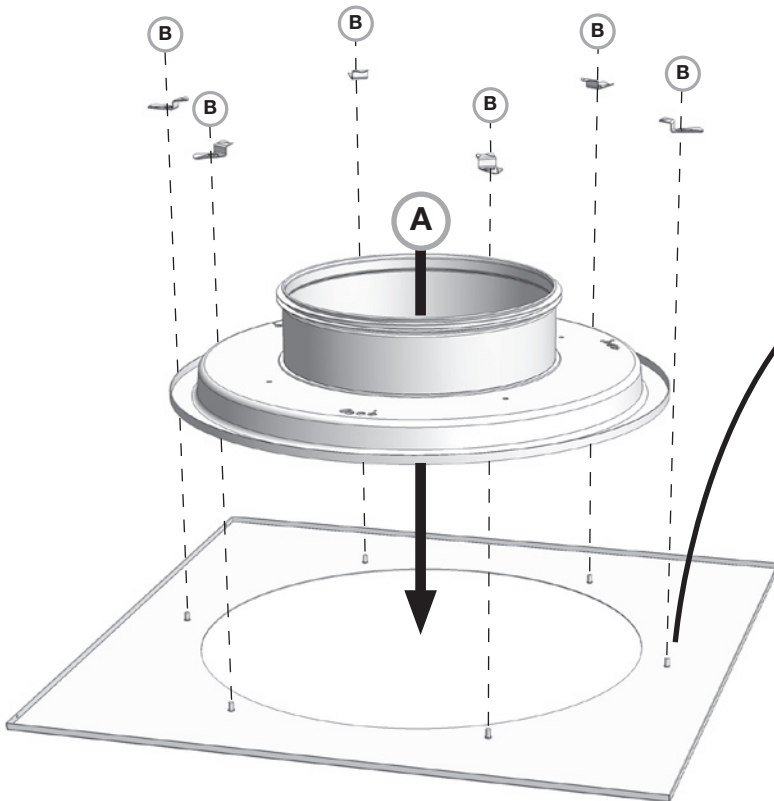
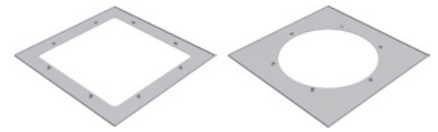

!
UK - LM module plates adapted to ceiling system 1 - 21
DK - LM modulplader tilpasset loftsystem 1 - 21
SE - LM modulramar anpassat till undertakssystem 1 - 21
FI - LM-moduulilevyt sovitettu kattojärjestelmään 1-21
DE - LM Modulplatten angepasst für Deckensysteme 1-21
IT - La cornice LM è adatta per sistemi di controsoffitto tipo 1 - 21
FR - Plaque d'habillage LM adaptées aux systèmes de plafond 1 - 21
HU - LM adapter lemezt illesztjük az 1 - 21 álmennyezeti rendszerbe

LM

PKA, LKA, PCA, LCA

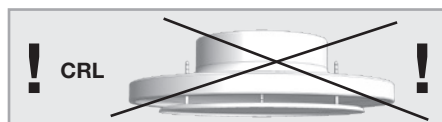
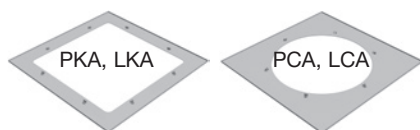

LM — **aa** — **bbb** — **ccc**
 1-21 —
 Ceiling system / Loftsystem
 Undertakssystem / Kattojärjestelmät
 Deckensysteme
 Sistemi di controsoffitto
 Type de plafond /
 Álmennyezeti rendszer

PKA
 LKA
 PCA
 LCA

ød

Formo

LM

Mounting of diffuser in ceiling with LM module plate
Montering af armatur i loft med LM modulplade
Montering av don i tak med LM modulram
Hajottajan asennus alakattoon LM-moduulilevyn kanssa.
Montage des Durchlasses in der Decke mit LM Modulplatte
Montaggio del diffusore nel controsoffitto usando la cornice LM
Montage du diffuseur dans le plafond avec plaque d'habillage LM
A befűvő szerelése a mennyezetbe LM adapter lemezzel

LM

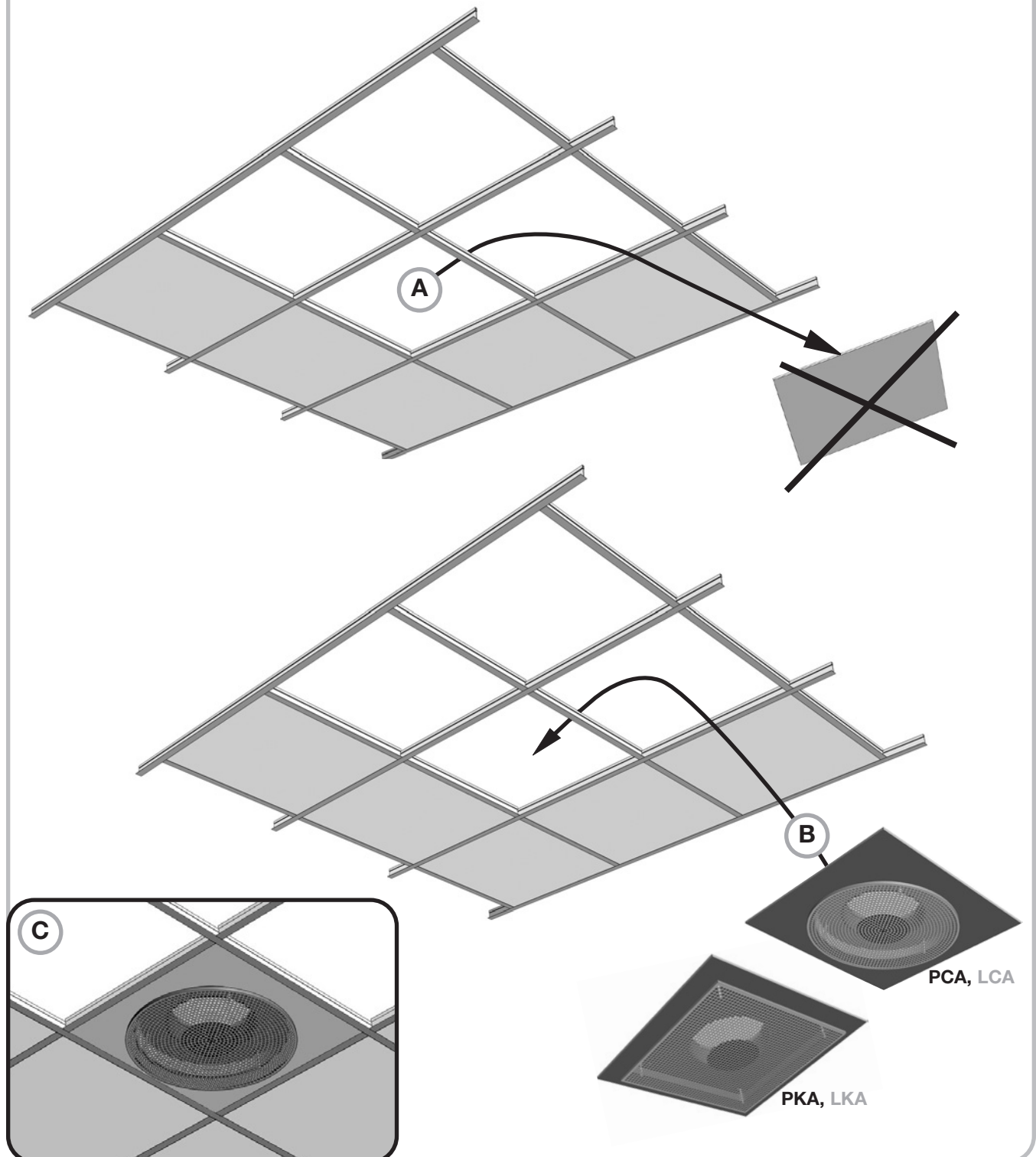
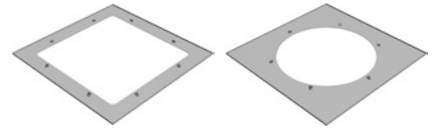

Formo

LM

Mounting of diffuser + MB/CBC/CBE in ceiling with LM module plate
Montering af armatur + MB/CBC/CBE i loft med LM modulplade
Montering av don + MB/CBC/CBE i tak med LM modulram
Hajottajan ja MB/CBC/CBE-liitäntälaatikon asennus alakattoon LM-moduulilevyn kanssa.
Montage des Durchlasses + MB/CBC/CBE in der Decke mit LM Modulplatte
Montaggio del diffusore + MB/CBC/CBE in controsoffitto con cornice LM
Montage du diffuseur + MB/CBC/CBE dans le plafond avec plaque d'habillage LM
A befűvő + MB/CBC/CBE szerelése a mennyezetbe LM adapter lemezzel

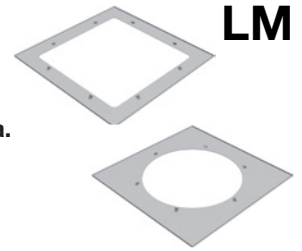

!

UK - The MB/CBC/CBE must shortly be lifted - Otherwise see next page.
DK - MB/CBC/CBE boksen må et øjeblik løftes - Ellers se næste side.
SE - MB/CBC/CBE måste lyftas kort - annars se nästa sida.
FI - MB/CBC/CBE-laatikkoa kannatellaan asennuksen ajan - Muutoin katso seuraava sivu.
DE - Der MB/CBC/CBE muss kurzzeitig nach oben gedrückt werden - Sonst siehe nächste Seite.
IT - MB/CBC/CBE deve essere sollevabile - in caso contrario vedere pagina seguente.
FR - Le MB/CBC/CBE doit être légèrement surélevé - alternative voir page suivante.
HU - Az MB/CBC/CBE dobozt fel kell emelni - Másképp lásd a következő oldalon.

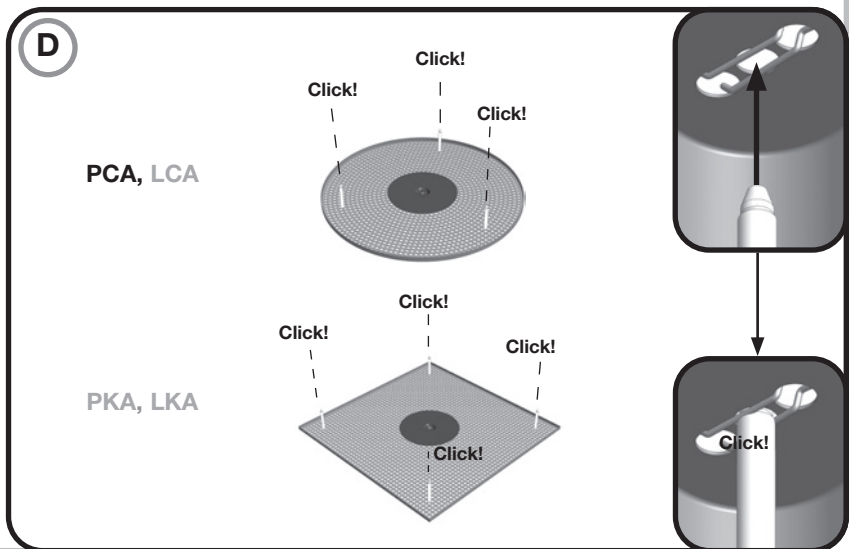
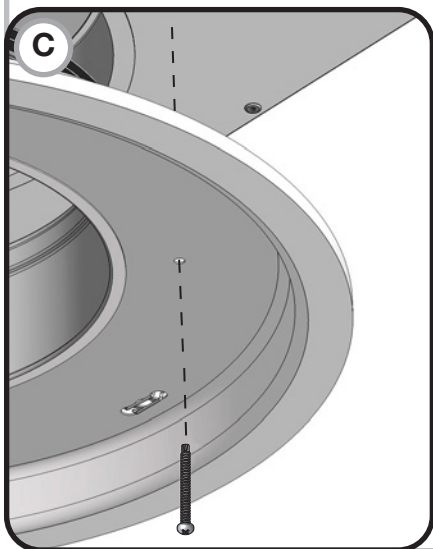
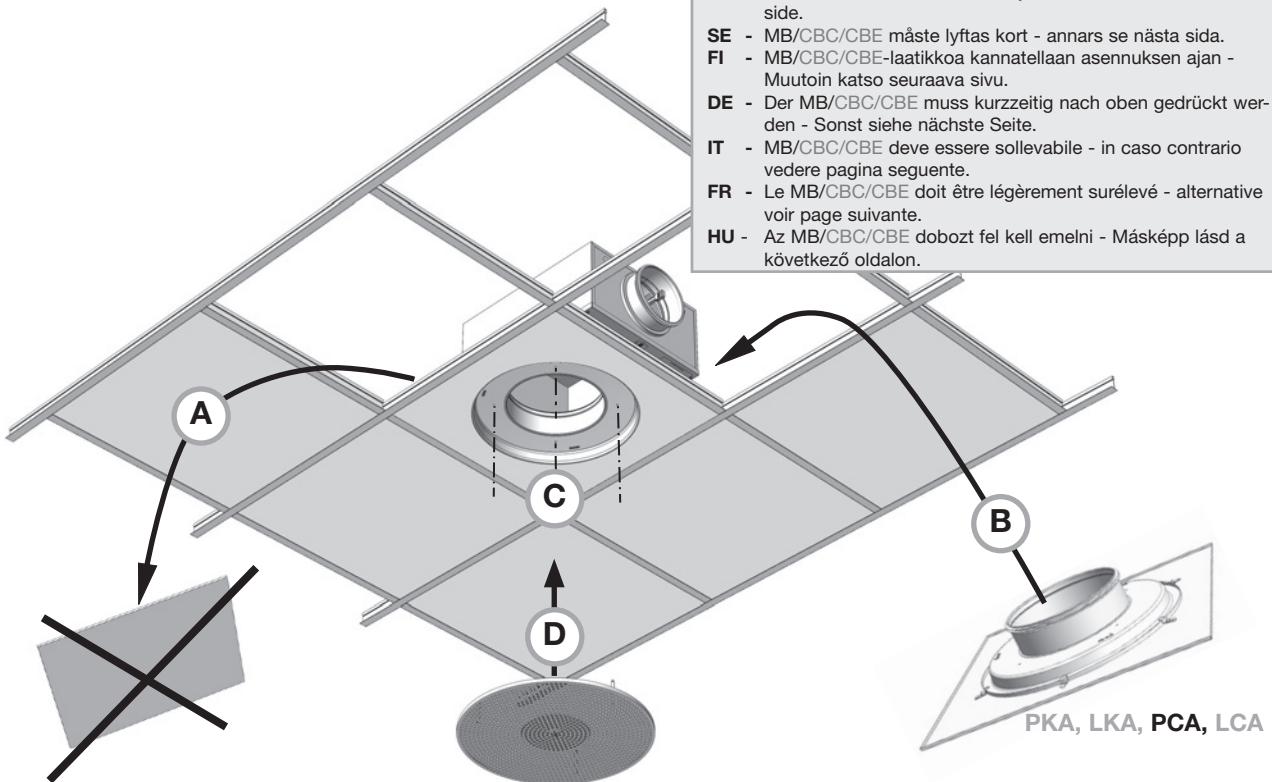

Formo

LM

Mounting of diffuser + MB/CBC/CBE in ceiling with LM module plate
Montering af armatur + MB/CBC/CBE i loft med LM modulplade
Montering av don + MB/CBC/CBE i tak med LM modulram
Hajottajan ja MB/CBC/CBE-liitäntälaatikon asennus alakattoon LM-moduulilevyn kanssa.
Montage des Durchlasses + MB/CBC/CBE in der Decke mit LM Modulplatte
Montaggio del diffusore + MB/CBC/CBE in controsoffitto con cornice LM
Montage du diffuseur + MB/CBC/CBE dans le plafond avec plaque d'habillage LM
A befűvő + MB/CBC/CBE szerelése a mennyezetbe LM adapter lemezzel

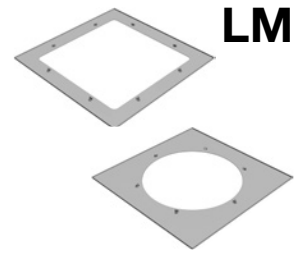

!

- UK** - Not enough space above suspended ceiling when mounting MB/CBC/CBE + LM - Remove one T-runner while mounting
DK - For lidt plads over nedsænket loft ved montage af MB/CBC/CBE + LM - Fjern en loft-skinne under montage
SE - Vid otillräcklig plats ovan undertaket vid montage av MB/CBC/CBE+LM - Demontera en undertaksskena vid montage
FI - Jos alakaton yläpuolella ei ole tarpeeksi tilaa asennuksen aikana, poista yksi T-lista asennuksen ajaksi
DE - Wenig Platz im Deckenhohlraum bei Montage MB/CBC/CBE + LM - Entfernen Sie einen T-Träger für die Montage
IT - In caso non vi sia spazio in fase di montaggio dell'MB/CBC/CBE + LM - Smontare una barra a T
FR - Pas assez de place dans le plafond lors du montage de MB/CBC/CBE + LM - Retirer un support en T pendant le montage
HU - Az MB/CBC/CBE + LM szerelésekor nincs elég hely az álmennyezet felett - Szerelés közben távolítsa el egy T-sínt!

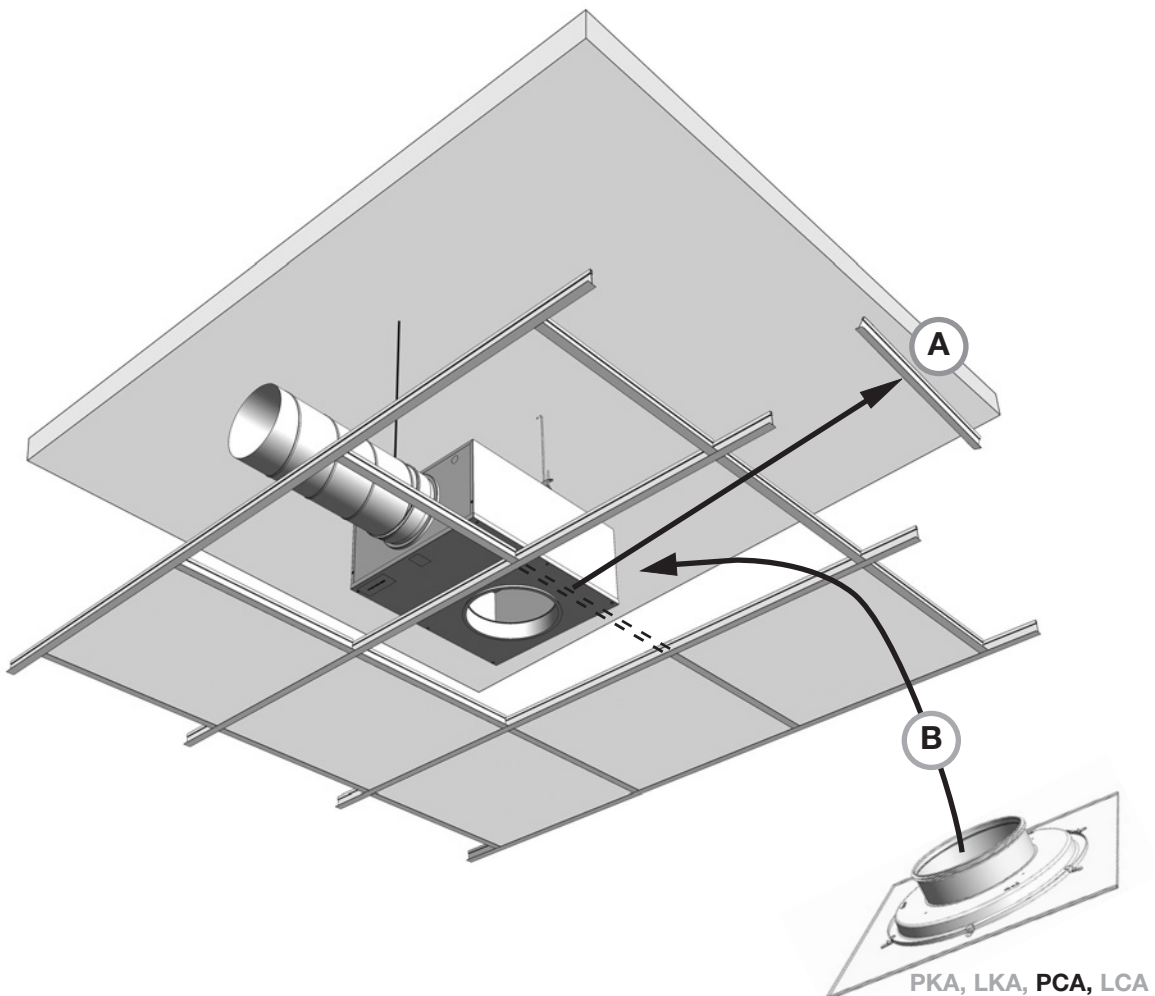

Formo

LM

Overview LM module plates
Oversigt LM modulplader
Översikt LM Modulramar
Yleiskatsaus LM Moduulilevy
Übersicht LM Modulplatten
Panoramica LM Piastra modulare per controsoffiti
Aperçu plaques d'habillage LM
Áttekintés LM adapter lemezek

! **LM**

UK - LM module plate adapted to ceiling system 1 - 21
DK - LM modulplader tilpasset loftsystem 1 - 21
SE - LM modulramar anpassat till undertakssystem 1 - 21
FI - LM-moduulilevy sovitettu kattojärjestelmään 1-21
DE - LM Modulplatten angepasst für Deckensysteme 1-21
IT - La cornice LM è adatta per sistemi di controsoffitto tipo 1 - 21
FR - Plaques d'habillage LM adaptées aux systèmes de plafond 1 - 21
HU - LM adapter lemezt illesztjük az 1 - 21 álmennyezeti rendszerbe

1, 21

1. = 600 x 600
 21.= 625 x 625

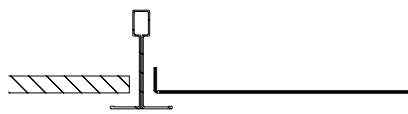

4, 5, 6

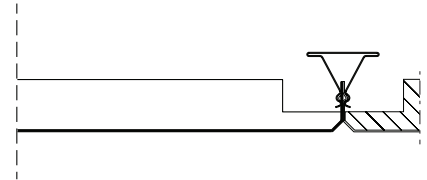
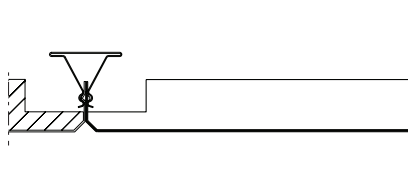

7, 8

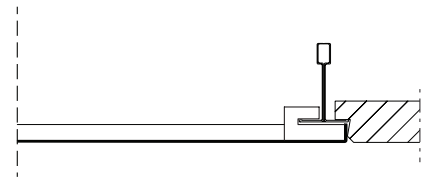
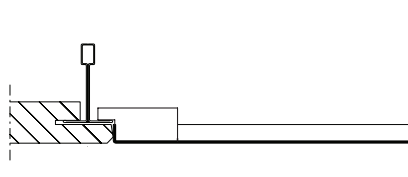

9, 10

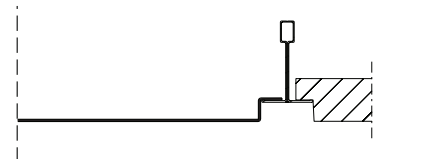
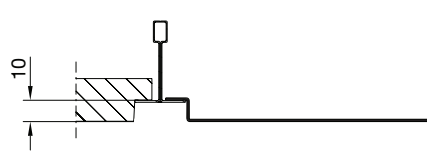

11

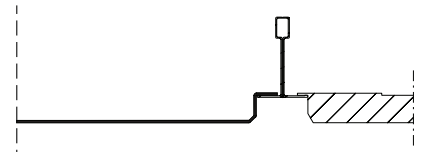
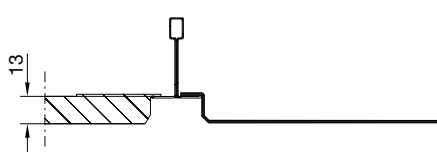

14

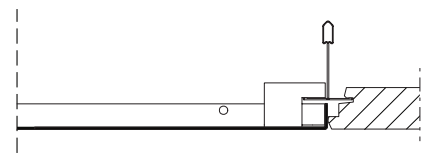
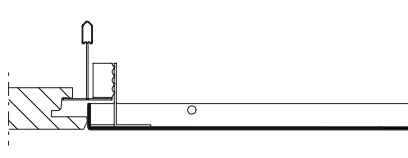

Formo

Overview - Ceiling systems

Oversigt - loftsystemer

Översikt - Undertakssystem

Yleiskatsaus - Kattojärjestelmät

Übersicht - Deckensysteme

Panoramica - Sistemi di controsoffitto

Aperçu - Systèmes de plafond

Áttekintés - Álmennyezeti rendszerek

1.
21.

T24/T15 = 600 x 600
22 = 625 x 625

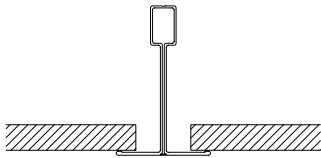

3.

Permanent ceiling
Fast loft / Fast undertak
Kiinteä alakatto
Geschlossene Decke
Soffitto permanente
Plafond non démontable
Monolit álmennyezet



4.

Dampa Clip-in

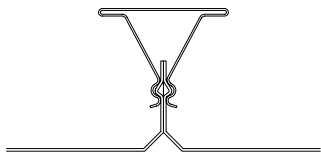

5.

Dampa Clip-in

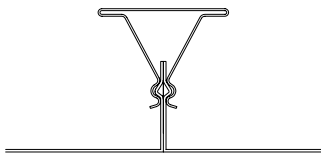

6.

Luxalon Clip-in

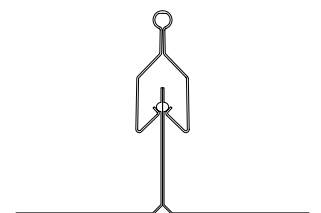

7.

Danotile Contur / Ecophon D
Rockfon D-XL

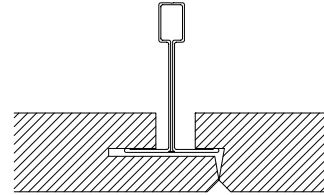

8.

Ecophon Focus DG

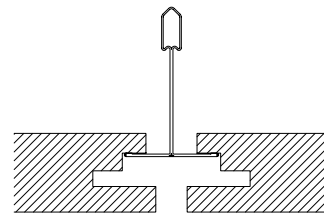

9.

Rockfon E10 24 / Ecophon E / T24

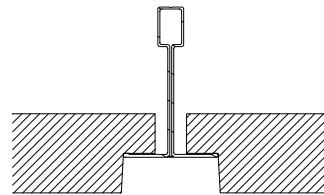

10.

Rockfon E10 15 / Ecophon E / T15

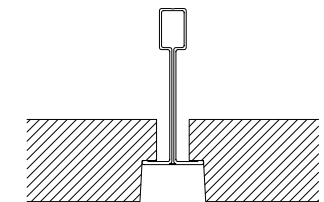

11.

Danotile Markant

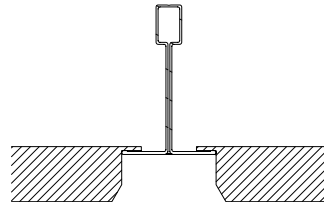

14.

Ecophon Focus DS

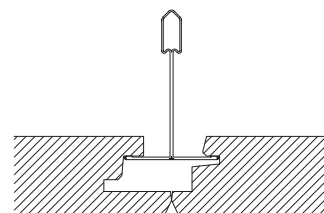



Most of us spend the majority of our time indoors. Indoor climate is crucial to how we feel, how productive we are and if we stay healthy.

We at Lindab have therefore made it our most important objective to contribute to an indoor climate that improves people's lives. We do this by developing energy-efficient ventilation solutions and durable building products. We also aim to contribute to a better climate for our planet by working in a way that is sustainable for both people and the environment.

[Lindab](#) | For a better climate