

Exhaust valve

KU

1

2

3

4

5



6

Description

Valve for exhaust air.
Designed for wall or ceiling mounting.
Bayonet holders connect to socket VRGU, VRGL or VRGM.

7

8

Materials and finish

Material
Powder-coated galvanized sheet metal.

9

Colour
White RAL 9010, gloss 30, equivalent to NCS S 0502 Y.

10

11

12

13

14

15

16

17

18

Order code



Dimensions

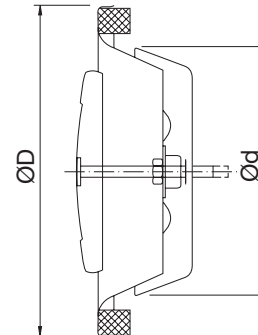

$\text{\O}d$ nom	$\text{\O}D$ mm	m kg
80	110	0,13
100	130	0,19
125	160	0,27
150	188	0,36
160	190	0,38
200	245	0,58

Exhaust valve

KU

Technical data

Air flow, q [l/s] and [m³/h], total pressure drop, Δp_t [Pa], and A-weighted sound power level, L_{WA} [dB], for different settings, a [mm], are shown in the graphs.

Sound power level, L_{Wok} [dB], in octave bands

is calculated as $L_{WA} + K_{ok}$. K_{ok} is found in the table below.

Ød nom	Valve mounted in	Centre frequency [Hz]							
		63	125	250	500	1K	2K	4K	8K
100	Duct	-	-8	-5	-6	-6	-4	-12	-21
125	Duct	-	-11	-4	-6	-7	-3	-16	-25
160	Duct	-	-7	-4	-6	-3	-6	-18	-31
200	Duct	-	-7	-6	-7	-2	-9	-18	-27

Tolerance	-	±3	±2	±2	±2	±2	±2	±3
-----------	---	----	----	----	----	----	----	----

Sound attenuation, ΔL , [dB]

Ød nom	Valve mounted in	Setting a [mm]	Centre frequency [Hz]							
			63	125	250	500	1K	2K	4K	8K
100	Duct	-12	21	18	12	14	12	11	12	15
		-5	21	16	9	11	9	8	8	12
		5	21	16	8	10	8	7	5	11
125	Duct	-17	22	16	11	9	7	7	9	12
		-9	21	16	9	8	5	5	7	8
		5	20	15	9	6	4	3	4	7
160	Duct	-15	19	14	9	8	6	7	9	10
		-5	19	13	9	6	5	4	6	8
		5	18	13	8	5	4	3	6	6
200	Duct	-25	17	12	10	9	9	12	14	12
		0	16	10	7	6	6	6	10	7
		20	16	10	6	4	4	5	9	6

Tolerance	±6	±3	±2	±2	±2	±2	±2	±3
-----------	----	----	----	----	----	----	----	----

Measurement of air flow

Data is available in a separate brochure.

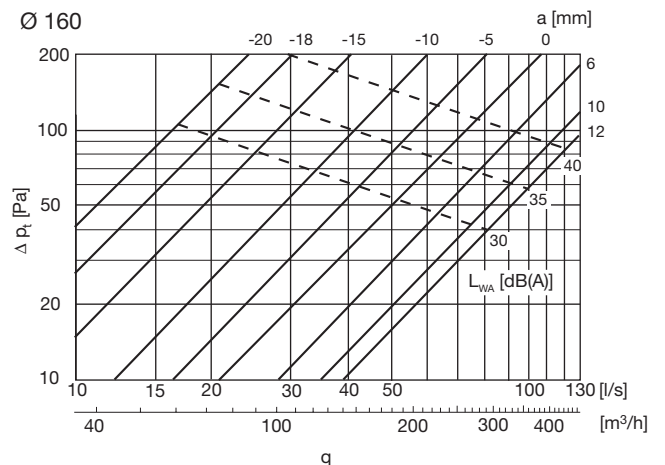
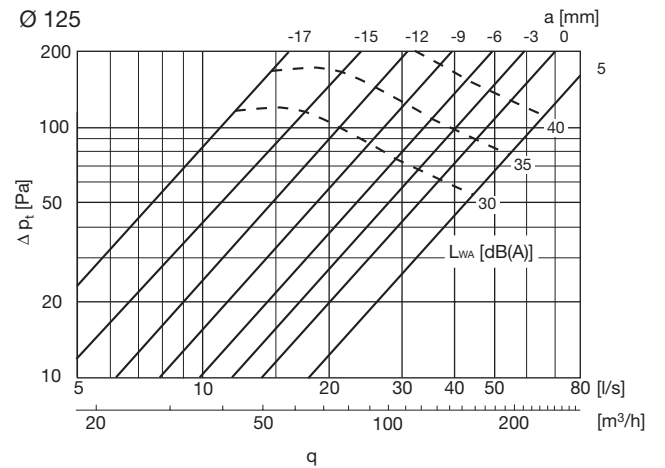
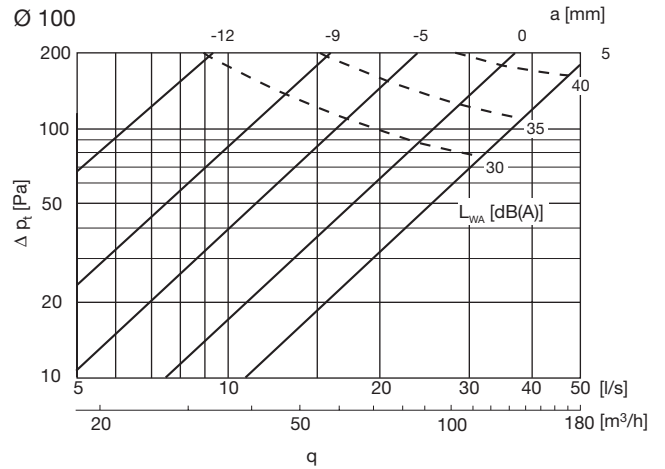

- 1
- 2
- 3
- 4
- 5
- 6
- 7
- 8
- 9
- 10
- 11
- 12
- 13
- 14
- 15
- 16
- 17
- 18

Exhaust valve

KU

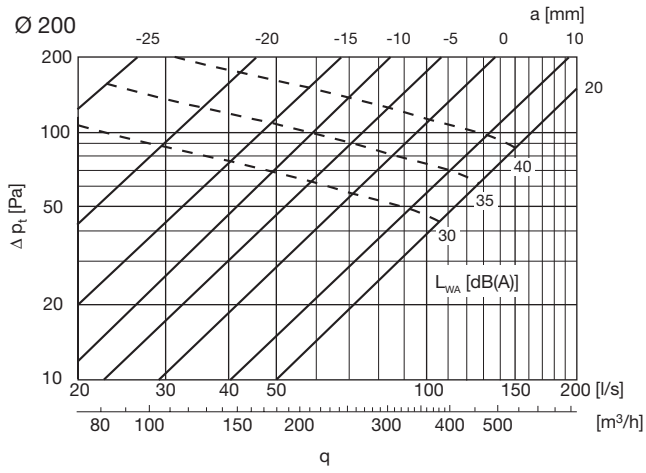

- 1
- 2
- 3
- 4
- 5
- 6
- 7
- 8
- 9
- 10
- 11
- 12
- 13
- 14
- 15
- 16
- 17
- 18